

User manual

Genius PLUS[®]



Genius PLUS X[®]



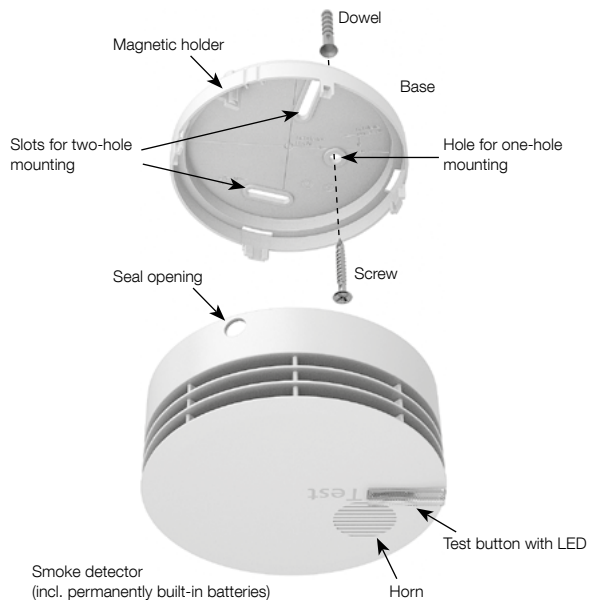

Contents

1	Properties of the Genius Plus® / Plus X®	4
2	Mounting location and planning	6–10
3	Notice for renovation work	11
4	Installing the smoke detector	12–15
5	Theft and removal protection (accessory)	16
6	Function of the test button	18
7	Status query via smartphone and app	19
8	Operating and warning signals	20
9	Maintenance and care	22
10	Safety information	24
11	Note about disposal	25
12	Environment	25
13	Technical data	26
14	Index	28

Properties of the Genius Plus®/Plus X®

Automatic operational readiness

After the smoke detector is screwed into the base, it starts operating automatically.

Suitable for the bedroom

Automatic deactivation of the LED and suppression of status messages from 9 p.m. to 7 a.m. CET¹ (night mode) according to the integrated real-time clock.

Soiling compensation

The detector adjusts its alarm sensitivity according to its level of soiling and thus achieves a longer service life than smoke detectors without compensation. In the event that the maximum

soiling level is reached through adjustments, a fault is signalled.

Soiling prognosis

Based on the level of previous soiling, the smoke detector calculates how long it can still be operated safely if the ambient conditions remain the same.

Time-delayed deactivation

The smoke detector is deactivated automatically 5 minutes after removing it from the base.

Properties of the Genius Plus®/Plus X®

Testing once annually

Thanks to continuous self-monitoring, manual testing only has to be performed once annually.

smartsonic

Data transmission to the Genius Home and Genius Pro smartphone apps. During acoustic transmission, all relevant data from the smoke detector and radio module (if present) is transferred. For more information, see Section 7.

Optional radio networking (Genius Plus X® only)

The Genius Plus X® has a corresponding interface for connecting a Genius Basis X or Pro X radio module.

No battery replacement required

Thanks to the permanently built-in lithium batteries with a 10-year service life, no replacement is necessary.



According to DIN 14676, the device must be replaced after 10 years and 6 months, at the latest.

¹ CET: Central European Time (wintertime)

Mounting location and planning

The minimum configuration consists of mounting at least one smoke detector in each bedroom, children's room and in the hallway.

For **optimal configuration**, mount at least one smoke detector in each room, hallway and entrance area.

Mount the smoke detectors so that smoke from a fire can reach the detector unimpeded to ensure early detection.

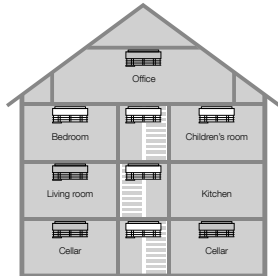

Minimum configuration

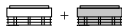

Optimal configuration

Mounting location and planning

Smoke detectors must always be mounted on the ceiling, preferably in the centre of the room but in all cases at least 0.5m from the walls, beams

or items of furniture. A smoke detector monitors a maximum room area of 60 m².

Where?

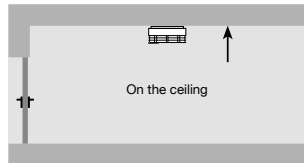

How far away from walls and other objects?

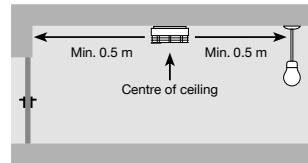

How high?

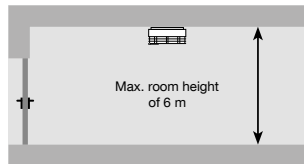

Size of room area?

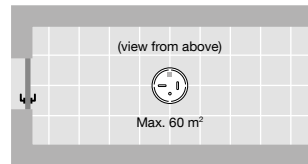

Please note that living rooms are often also used for sleeping and should be monitored with smoke detectors.

If the detector is mounted in a ceiling peak, the following applies to the ceiling angle:

- A ceiling angle up to 20° is treated the same as a horizontal ceiling

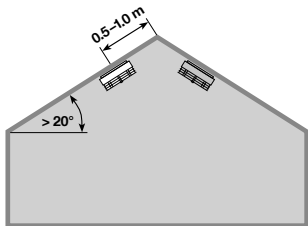

 Alternative positioning of the detector

- For a ceiling angle of more than 20° , mount the detector at least 0.5 m to max. 1 m from the ceiling peak on the ceiling/roof

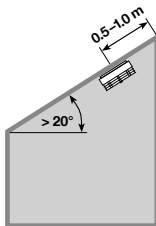

 Smoke detectors are not intended for outdoor use.

2.1

Mounting smoke detectors in special installation conditions

In the following circumstances, smoke detectors can be mounted sideways on the longest wall of the room and as close to the centre as possible:

- If mounting on the ceiling is not possible, e.g. with textile ceilings, ceiling heating or if the ceilings are not strong enough.
- If an increased number of false alarms can be expected as a result

of ceiling mounting. However, this only applies to rooms and hallways with an area of $\leq 6 \text{ m}^2$ or kitchens that are used as escape routes.

With wall mounting, the following distances must be maintained to items of furniture (measured from the centre of the detector):

Distance to the ceiling:

$a = 0.3$ to 0.5 m

Distance underneath:

$b \geq 1 \text{ m}$

Minimum distance at the side:

$c > 0.5 \text{ m}$



Wall mounting of a smoke detector

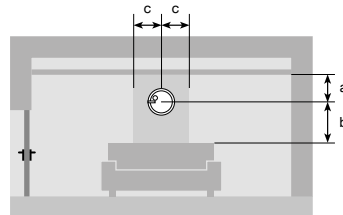

2.2

Arranging smoke detectors in hallways and entrance areas

In rooms and hallways with a width of < 1 m, the smoke detector is mounted in the centre of the ceiling between the walls.

In entrance areas and hallways with a maximum width of 3 m, the distance between two smoke detectors may be up to 15 m. The distance to the front side of an entrance area may not be greater than 7.5 m.

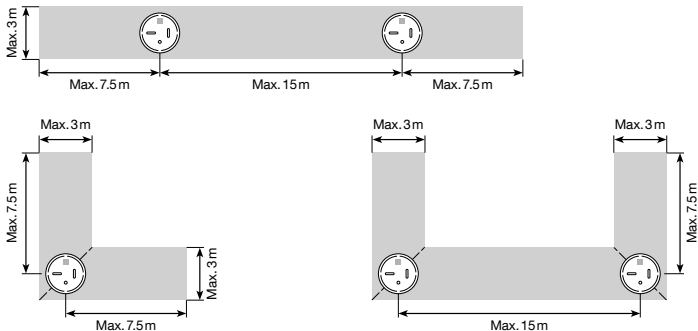

3

Notice for renovation work

Mount the smoke detector only after all modifications, renovations and similar work have been completed.

When smoke detectors are used in environments with high levels of dust and/or dirt, their service life may be reduced due to faster soiling.

If smoke detectors are already installed before beginning work, they must either be removed or covered.

The removed smoke detectors must be protected from dust and similar substances during the work (e.g. stored in plastic bags).

! Once all work is completed, the smoke detectors must be remounted and the coverings removed. A smoke detector that is not mounted or still covered will not function and is therefore useless.

4

Installing the smoke detector

Mounting with screws and dowels

Use the supplied fastening materials when mounting the smoke detector. If other screws are used, the screw heads must not protrude more than 5.0 mm into the base.

We recommend using a 3.5 x 25 mm pan head screw. The mounting surface must be flat!

For a safe and durable connection, Hekatron recommends mounting with screws and dowels.

Mounting with adhesive pad

When using an adhesive pad for mounting the detector, only the adhesive pad from Hekatron may be used. This must be ordered separately. Surfaces on which the adhesive pad is to be mounted must be smooth, flat, undamaged, clean and free of dust, grease and solvents.



Please also note the information on theft and removal protection (Section 5) on page 16.

Installing the smoke detector

4.1

Mounting with screws and dowels

1. Mark the place for the dowel on the ceiling and drill a hole. Insert the dowel into the hole.
2. Remove the protective foil from the small fixing pad (see footnote on page 14).
3. Insert the screw through the hole for one-hole mounting and screw in half-way. Align the base, press the base onto the ceiling and tighten the screw.
4. Position the smoke detector on the base so that the round seal opening on the detector lies flush above the magnetic holder of the base.
5. Turn the detector clockwise until the base goes into it and the detector snaps into place (rotation of about 15°).

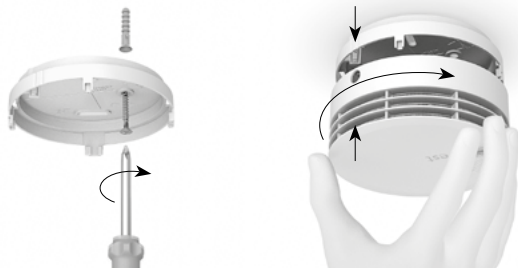

For mounting with two screws, hold the base on the ceiling in order to fasten it in place. Insert the screws through the two slots. The fixing pad¹ is not required for two-hole mounting.

¹ The small fixing pad is designed to act only as an anti-twist safeguard when inserting and removing the smoke detector in one-hole mounting.

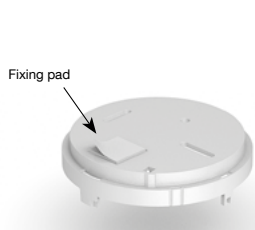

As soon as the smoke detector is screwed into the base, it begins operation automatically and carries out a self-test. When the smoke detector is removed from the base, it switches off after 5 minutes.



4.2

Mounting with adhesive pad (accessory)¹

1. Remove the protective foil on one side of the adhesive pad and affix the pad to the base of the smoke detector. The fixing pad must be positioned exactly in the recess.

2. Remove the second protective foil on the adhesive pad and affix the base onto the previously cleaned and marked position by pressing it firmly in place (for at least 5 seconds).

3. Mount the smoke detector on the base as described in Section 4.1 («Mounting with screws and dowels»).

¹ For adhesive mounting, the adhesive pad for Genius smoke detectors must be ordered separately.



Adhesive pads may leave residue when removed. Use adhesive pads at your own risk. When using the adhesive pad, be sure to follow the adhesive pad mounting instructions for Genius smoke detectors (art. no. 700270).

5

Theft and removal protection (accessory)

To secure the smoke detector against removal by unauthorised persons, removal protection in the form of a seal can be ordered separately.

Proceed as follows to attach the seal:

1. Remove the predetermined breaking point in the base using thin pliers. After mounting the base to the ceiling, attach the smoke detector to the base.
2. Insert the seal into the opening.

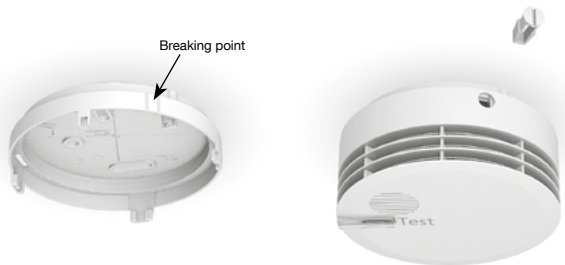

Theft and removal protection (accessory)

3. After the seal is inserted, the opening must be completely closed.

4. To remove the seal, rotate it 90° using a screwdriver. This shears off the head of the seal and you can then rotate the detector out of the base normally.

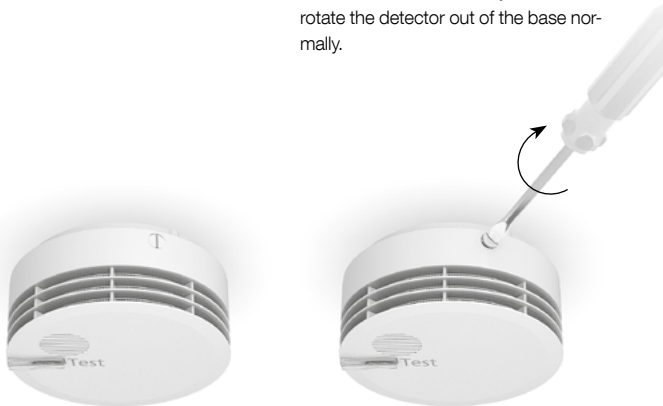

6

Function of the test button

The test button triggers and mutes the various functions of the smoke detector.

By pressing the test button **briefly**, you can

- Start the function test in normal operation
- Mute a fault
- Mute an alarm
- Delete the alarm memory
- Trigger the line test (Genius Plus X® in combination with a radio module).

By pressing the test button for a **longer** period (at least 3 seconds), you can

- Start the smartsonic data transmission to the Genius apps



7

Status query via smartphone and app

For status queries via smartphone, please activate «Function test» in the corresponding Genius Home or Genius Pro app.

Press the test button and hold it down for at least 3 seconds until transmission via Hekatron smartsonic begins.

smart#sonic



Compatible with the Genius Home and Genius Pro apps on all conventional smartphones.



Operating and warning signals

Fire alarm¹

Horn	Test button	Cause	What to do
Alternating, loud alarm tone	Flashes RED every second	Smoke has been detected	Leave the building
Off	Double GREEN flashing every 48 seconds	Alarm memory, fire alarm on this smoke detector	Search the surrounding area for causes of smoke. Reset the alarm memory by pressing the test button.

Signalling during the day (7 a.m. to 9 p.m. CET^{1,2})

Horn	Test button	Cause	What to do
Off	Flashes GREEN every 48 seconds (off at night)	Normal operation	----
Once every 48 seconds Short signal tone	Flashes ORANGE every 8 seconds (off at night)	End of device life cycle	Replace the device. Mute by pressing the test button. ³
Once every 48 seconds Short signal tone	Flashes RED every 8 seconds (off at night)	Error detected	Replace the device. Mute by pressing the test button. ³

¹ Standalone operation ² CET: Central European Time (wintertime)

³ The respective state of the smoke detector can be interpreted and displayed using the Genius Home and Genius Pro apps.

Signalling on the day after being muted for 24 hours¹

Horn	Test button	Cause	What to do
Off	Flashes ORANGE every 48 seconds (off at night)	End of device life cycle	Replace the device
Off	Flashes RED every 48 seconds (off at night)	Error detected	Replace the device

¹ Standalone operation

Signalling when using radio modules (Genius Plus X[®] only)

Horn	Test button	Cause	What to do
Off	GREEN-ORANGE-RED chase lighting every 8 seconds	No radio connection	Carry out radio commissioning according to the user manuals for radio operation

Maintenance and care

To ensure the functional reliability of the detector, maintenance must be performed at least once every 12 months (+/- 3 months) according to DIN 14676. Proceed as follows:

1. If needed, remove dust from the detector with a soft cloth.
2. If needed, remove dirt with a moist cloth. Do not use cleaning agents.

3. Check the following:

- Are the smoke inlet openings free?
- Is the detector damaged?
- Is there space of > 0.5 m around the smoke detector?
- Has the room use been changed?

4. Carry out a function test by pressing the test button (see the corresponding table).



Testing of the alarm capability must be performed exclusively using the test button. Due to its internal alarm filter, the Genius Plus® / Plus X® smoke detector is not suitable for alarm release using test gas.

When carrying out maintenance and care on networked radio smoke detectors, also observe the user manual for the radio modules.



Signalling		State
Test button	Horn ¹	
Flashes once GREEN	Positive self-test tone Once at same time as LED	Feedback of positive function test
Flashes once GREEN	Negative self-test tone Once at same time as LED	«End of device life cycle» possible due to soiling within 15 months
Flashes once ORANGE	Negative self-test tone Once at same time as LED	Feedback of function test «End of device life cycle», replace device²
Flashes once RED	Negative self-test tone Once at same time as LED	Feedback of function test «Error detected», replace device²

¹ According to the **DIN EN 14604** standard, audible signalling is sufficient.

² The respective state of the smoke detector can be interpreted and displayed using the Genius Home and Genius Pro apps.

5. Additionally, a detailed status query can be made via smartphone app (see Section 7). Transmission to the Genius Home and Genius Pro apps is started using the test button (press and hold for at least 3 seconds).

6. Document the results and take corrective measures as part of maintenance work, when necessary.

Safety information

The purpose of smoke detectors is to warn you early about fire smoke and fires so that you can react quickly to danger with the appropriate measures. Smoke detectors cannot prevent or extinguish fires.

These smoke detectors react early and reliably to smouldering fires as well as to open fires that develop smoke. The detector audibly outputs a loud alarm tone and visually displays a flashing red light when it detects smoke. Ensure that a sufficient number of smoke detectors are mounted. Only in this way is it possible to achieve comprehensive monitoring and maximum safety (see mounting location and planning in Section 2).

It is not permitted to paint the smoke detector or cover the smoke inlet openings. To ensure proper operation of the smoke detector, the smoke detector must be mounted correctly and maintenance and care instructions must be observed.

Hekatron recommends that planning, mounting, commissioning and maintenance are carried out according to DIN 14676. Please read these mounting instructions completely before mounting and commissioning the smoke detector and keep them in a safe place.

Note about disposal

Consumers are legally responsible for returning all electrical and electronic devices to communal collection points. This is an important contribution to environmental protection.

Disposing of such devices as household waste is prohibited.



Hekatron has covered the cost for disposal by paying the EAR fee for you.

The batteries are permanently built into the detector and cannot be replaced.

Environment

Our smoke alarms are produced in line with quality and environmental management standards according to DIN EN ISO 9001 and DIN EN ISO 14001. The Genius Plus® / Plus X® smoke detector fulfils the statutory RoHS requirements and does not contain any prohibited materials.

Technical data

VdS approval	DIN EN 14604 / VdS + Q-label G no.: 215026 (Genius Plus®) / 215027 (Genius Plus X®)
Declaration of performance	CPR-31-13-029-de-en (Genius Plus®) CPR-31-13-030-de-en (Genius Plus X®)
Audible alarm	Sound pressure level above 85 dB(A) (3m)
Audible alarm perception	Frequency optimisation for human hearing
Area of application	According to DIN 14676
Operation	Via test button
Intuitive operation levels	Yes
Operating state display	green/orange/red
Fault suppression at night ¹	Automatic with real-time clock
Fault suppression during day	For 24 hours by pressing the test button
Deactivation of the LED at night	Automatic with real-time clock
Voltage supply for detector	3.6 V lithium batteries, permanently built in ^{2, 3}
Battery capacity Genius Plus®	2 × 2.2 Ah smoke detectors
Battery capacity Genius Plus X®	1 × 2.2 Ah smoke detector 1 × 2.2 Ah for radio module
Detector battery service life	Typically 10 years
Automatic self-monitoring	Yes
Automatic adjustment for temperature fluctuations	Yes
Active soiling tracking	Yes

Technical data

Alarm memory	Yes
Active soiling prognosis	Yes, signalling by pressing test button
Theft protection	Via seal (accessory)
Optical removal detection	Via seal (accessory)
Storage temperature	-10° C to +60° C
Ambient operating temperature	0° C to 55° C
Ambient humidity (continuous, without condensation)	At ≤ +40° C, 10 to 70% rel. hum.
Protection type	IP 40
Colour	White satin finish, similar to RAL 9010
Material	PC-ABS
Height/Diameter dimensions	48 mm × 104 mm
Weight with base	Approx. 162 g (Genius Plus® / Genius Plus X®)
One-hole mounting/Two-hole mounting/Adhesive mounting	Yes
RoHS/WEEE compliant	Yes
Environmentally compliant disposal	Regulated through EAR

¹ From 9 p.m. to 7 a.m. Central European Time (wintertime).

² For reasons of safety, an uninterrupted voltage supply is necessary for the smoke detector.

³ The optional radio modules are supplied with power via an internal battery on the Genius Plus X®.

Subject to technical modifications and colour variations. No liability for errors or printing mistakes!

Index

- A**
Ambient operating temperature .. 27
- B**
Battery replacement5
- D**
Deactivation4
- I**
Installation 12
- M**
Maintenance and care..... 22
Minimum configuration.....6
Mounting location.....6
Mounting with adhesive pad 15
Mounting with screws and
dowels 13
- O**
Operating and warning signals.. 20
- P**
Planning6
Properties.....4
- S**
Seal 16
Signalling..... 20
smartsonic 5
Soiling compensation4
Soiling prognosis4
Storage temperature 27
Suitable for the bedroom..... 4
Switching on and off 14
- T**
Technical data 26
Test button 18
Theft and removal protection..... 16

Securiton AG
Alarm and Security Systems
Alpenstrasse 20, CH-3052 Zollikofen
Tel. +41 58 910 50 50
www.securiton.ch, info@securiton.ch

A company of the Swiss Securitas Group